



Pressure Seals, Inc.

Phone: (877)-PSI-SEAL Toll Free
Thousands of Seals, O-Rings, and U-Cups
World-Class Service since 1976!



Part Numbering System:

Example: **TF1188 P XXX-XXX X**

Basic Part Number: TF1188
Seal Type: P
Dash Number: XXX-XXX
Jacket Material: X
Spring Material: X

Jacket Material Code:

Code Description
490 Glass-Moly-filled TFE
600 Carbon-Graphite-filled TFE

CODE IDENT. 07128

TF 1188P

SEAL INSTALLATION
O.D MOUNTED, STATIC ONLY
COMMERCIAL-INDUSTRIAL STANDARD

Spring Material Code:

Code	Description
A	301 SST
B	Inconel 718
C	Elgiloy®
D	Hastelloy C
E	304 SST
F	17-7PH SST
G	316 SST
H	302 SST

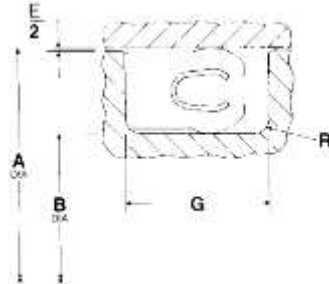

Dash No.	G Groove Width +0.005 -0.000	R Groove Radius	E Diametral Clearance Max.
	010-050	0.093	.005-.015
107-178	0.140	.005-.015	0.005
204-284	0.187	.010-.025	0.006
311-395	0.281	.020-.035	0.006
425-475	0.375	.020-.035	0.007

Dash No.	A Dia.	B Dia.	Dash No.	A Dia.	B Dia.	Dash No.	A Dia.	B Dia.	Dash No.	A Dia.	B Dia.	Dash No.	A Dia.	B Dia.
	+0.02	+0.00		+0.02	+0.00		+0.02	+0.00		+0.02	+0.00		+0.02	+0.00
	-0.00	-0.02		-0.00	-0.02		-0.00	-0.02		-0.00	-0.02		-0.00	-0.02
010	0.375	0.275	044	3.879	3.775	134	2.068	1.900	168	7.437	7.275	227	2.375	2.153
011	0.437	0.337	045	4.129	4.025	135	2.131	1.963	169	7.687	7.525	228	2.500	2.278
012	0.500	0.400	046	4.379	4.275	136	2.193	2.025	170	7.937	7.775	229	2.625	2.403
013	0.562	0.462	047	4.629	4.525	137	2.256	2.088	171	8.187	8.025	230	2.750	2.528
014	0.625	0.525	048	4.879	4.775	138	2.312	2.150	172	8.437	8.275	231	2.875	2.653
015	0.687	0.587	049	5.129	5.025	139	2.375	2.213	173	8.687	8.525	232	3.000	2.778
016	0.750	0.650	050	5.379	5.275	140	2.437	2.275	174	8.937	8.775	233	3.125	2.903
017	0.812	0.712	107	0.412	0.243	141	2.500	2.338	175	9.187	9.025	234	3.250	3.028
018	0.875	0.775	108	0.443	0.275	142	2.562	2.400	176	9.437	9.275	235	3.375	3.153
019	0.937	0.837	109	0.505	0.338	143	2.625	2.463	177	9.687	9.525	236	3.500	3.278
020	1.000	0.900	110	0.568	0.400	144	2.687	2.525	178	9.937	9.775	237	3.625	3.403
021	1.062	0.962	111	0.630	0.463	145	2.750	2.588	204	0.625	0.403	238	3.750	3.528
022	1.125	1.025	112	0.693	0.525	146	2.812	2.650	205	0.687	0.465	239	3.875	3.653
023	1.187	1.087	113	0.755	0.588	147	2.875	2.713	206	0.750	0.528	240	4.000	3.778
024	1.250	1.150	114	0.818	0.650	148	2.937	2.775	207	0.812	0.590	241	4.125	3.903
025	1.312	1.212	115	0.880	0.713	149	3.000	2.838	208	0.875	0.653	242	4.250	4.028
026	1.375	1.275	116	0.943	0.775	150	3.062	2.900	209	0.937	0.715	243	4.375	4.153
027	1.437	1.337	117	1.005	0.838	151	3.187	3.025	210	1.000	0.778	244	4.500	4.278
028	1.500	1.400	118	1.068	0.900	152	3.437	3.275	211	1.062	0.840	245	4.625	4.403
029	1.625	1.525	119	1.130	0.963	153	3.687	3.525	212	1.125	0.903	246	4.750	4.528
030	1.750	1.650	120	1.193	1.025	154	3.937	3.775	213	1.187	0.965	247	4.875	4.653
031	1.875	1.775	121	1.255	1.088	155	4.187	4.025	214	1.250	1.028	248	5.000	4.778
032	2.000	1.900	122	1.318	1.150	156	4.437	4.275	215	1.312	1.090	249	5.125	4.903
033	2.125	2.025	123	1.380	1.213	157	4.687	4.525	216	1.375	1.153	250	5.250	5.028
034	2.250	2.150	124	1.443	1.275	158	4.937	4.775	217	1.437	1.215	251	5.375	5.153
035	2.375	2.275	125	1.505	1.338	159	5.187	5.025	218	1.500	1.278	252	5.500	5.278
036	2.500	2.400	126	1.568	1.400	160	5.437	5.275	219	1.562	1.340	253	5.625	5.403
037	2.625	2.525	127	1.630	1.463	161	5.687	5.525	220	1.625	1.403	254	5.750	5.528
038	2.750	2.650	128	1.693	1.525	162	5.937	5.775	221	1.687	1.465	255	5.875	5.653
039	2.875	2.775	129	1.755	1.588	163	6.187	6.025	222	1.750	1.528	256	6.000	5.778
040	3.000	2.900	130	1.818	1.650	164	6.437	6.275	223	1.875	1.653	257	6.125	5.903
041	3.125	3.025	131	1.880	1.713	165	6.687	6.525	224	2.000	1.778	258	6.250	6.028
042	3.375	3.275	132	1.943	1.775	166	6.937	6.775	225	2.125	1.903	259	6.500	6.278
043	3.625	3.525	133	2.005	1.838	167	7.187	7.025	226	2.250	2.028	260	6.750	6.528

Pressure Seals Inc. 81 Commerce Way, South Windsor, CT 06074

Phone: (877)-PSI-SEAL Toll Free, In CT: (860) 282-9100, Fax: (860) 282-9001



Pressure Seals, Inc.

Phone: (877)-PSI-SEAL Toll Free
Thousands of Seals, O-Rings, and U-Cups
World-Class Service since 1976!



TF 1188P continued

CODE IDENT. 07128

SEAL INSTALLATION
O.D MOUNTED, STATIC ONLY
COMMERCIAL-INDUSTRIAL STANDARD

Dash No.	A		Dash No.	B		Dash No.	A		Dash No.	B		Dash No.	A		Dash No.	B	
	Dia.	Dia.		Dia.	Dia.		Dia.	Dia.		Dia.	Dia.		Dia.	Dia.		Dia.	Dia.
	+002	+000		+002	+000		+002	+000		+002	+000		+002	+000		+002	+000
	-000	-002		-000	-004		-000	-004		-000	-004		-000	-004		-000	-004
261	7.000	6.778	318	1.375	1.035	351	5.125	4.785	384	15.375	15.035	446	9.000	8.548			
262	7.250	7.028	319	1.437	1.097	352	5.250	4.910	385	16.375	16.035	447	9.500	9.048			
263	7.500	7.278	320	1.500	1.160	353	5.375	5.035	386	17.375	17.035	448	10.000	9.548			
264	7.750	7.528	321	1.562	1.222	354	5.500	5.160	387	18.375	18.035	449	10.500	10.048			
265	8.000	7.778	322	1.625	1.285	355	5.625	5.285	388	19.375	19.035	450	11.000	10.548			
266	8.250	8.028	323	1.687	1.347	356	5.750	5.410	389	20.375	20.035	451	11.500	11.048			
267	8.500	8.278	324	1.750	1.410	357	5.875	5.535	390	21.375	21.035	452	12.000	11.548			
268	8.750	8.528	325	1.875	1.535	358	6.000	5.660	391	22.375	22.035	453	12.500	12.048			
269	9.000	8.778	326	2.000	1.660	359	6.125	5.785	392	23.375	23.035	454	13.000	12.548			
270	9.250	9.028	327	2.125	1.785	360	6.250	5.910	393	24.375	24.035	455	13.500	13.048			
271	9.500	9.278	328	2.250	1.910	361	6.375	6.035	394	25.375	25.035	456	14.000	13.548			
272	9.750	9.528	329	2.375	2.035	362	6.625	6.285	395	26.375	26.035	457	14.500	14.048			
273	10.000	9.778	330	2.500	2.160	363	6.875	6.535	425	5.000	4.548	458	15.000	14.548			
274	10.250	10.028	331	2.625	2.285	364	7.125	6.785	426	5.125	4.673	459	15.500	15.048			
275	10.750	10.528	332	2.750	2.410	365	7.375	7.035	427	5.250	4.798	460	16.000	15.548			
276	11.250	11.028	333	2.875	2.535	366	7.625	7.285	428	5.375	4.923	461	16.500	16.048			
277	11.750	11.528	334	3.000	2.660	367	7.875	7.535	429	5.500	5.048	462	17.000	16.548			
278	12.250	12.028	335	3.125	2.785	368	8.125	7.785	430	5.625	5.173	463	17.500	17.048			
279	13.250	13.028	336	3.250	2.910	369	8.375	8.035	431	5.750	5.298	464	18.000	17.548			
280	14.250	14.028	337	3.375	3.035	370	8.625	8.285	432	5.875	5.423	465	18.500	18.048			
281	15.250	15.028	338	3.500	3.160	371	8.875	8.535	433	6.000	5.548	466	19.000	18.548			
282	16.250	16.028	339	3.625	3.285	372	9.125	8.785	434	6.125	5.673	467	19.500	19.048			
283	17.250	17.028	340	3.750	3.410	373	9.375	9.035	435	6.250	5.798	468	20.000	19.548			
284	18.250	18.028	341	3.875	3.535	374	9.625	9.285	436	6.375	5.923	469	20.500	20.048			
	+002	+000	342	4.000	3.660	375	9.875	9.535	437	6.500	6.048	470	21.500	21.048			
	-000	-004	343	4.125	3.785	376	10.125	9.785	438	6.750	6.298	471	22.500	22.048			
311	0.937	0.597	344	4.250	3.910	377	10.375	10.035	439	7.000	6.548	472	23.500	23.048			
312	1.000	0.660	345	4.375	4.035	378	10.875	10.535	440	7.250	6.798	473	24.500	24.048			
313	1.062	0.722	346	4.500	4.160	379	11.375	11.035	441	7.500	7.048	474	25.500	25.048			
314	1.125	0.785	347	4.625	4.285	380	11.875	11.535	442	7.750	7.298	475	26.500	26.048			
315	1.187	0.847	348	4.750	4.410	381	12.375	12.035	443	8.000	7.548						
316	1.250	0.910	349	4.875	4.535	382	13.375	13.035	444	8.250	7.798						
317	1.312	0.972	350	5.000	4.660	383	14.375	14.035	445	8.500	8.048						

Pressure Seals Inc. 81 Commerce Way, South Windsor, CT 06074

Phone: (877)-PSI-SEAL Toll Free, In CT: (860) 282-9100, Fax: (860) 282-9001



Pressure Seals, Inc.

Phone: (877)-PSI-SEAL Toll Free
Thousands of Seals, O-Rings, and U-Cups
World-Class Service since 1976!



Part Numbering System:

Example: **TF1188 R XXX-XXX X**

Basic Part Number: TF1188
Seal Type: R
Dash Number: XXX-XXX
Jacket Material: X
Spring Material: X

Jacket Material Code:

Code Description
490 Glass-Moly-filled TFE
600 Carbon-Graphite-filled TFE

CODE IDENT. 07128

TF 1188R

SEAL INSTALLATION
I.D MOUNTED, STATIC ONLY
COMMERCIAL-INDUSTRIAL STANDARD

Spring Material Code:

Code	Description
A	301 SST
B	Inconel 718
C	Elgiloy®
D	Hastelloy C
E	304 SST
F	17-7PH SST
G	316 SST
H	302 SST

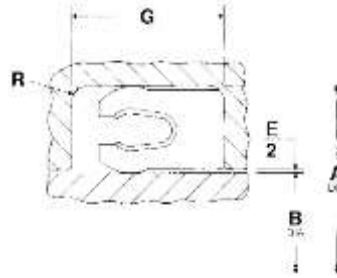

Dash No.	G Groove Width +005 -.000	R Groove Radius	E Diametral Clearance Max.
	010-050	0.093	.005-.015
107-178	0.140	.005-.015	0.005
204-284	0.187	.010-.025	0.006
311-395	0.281	.020-.035	0.006
425-475	0.375	.020-.035	0.007

Dash No.	A Dia.	B Dia.	Dash No.	A Dia.	B Dia.	Dash No.	A Dia.	B Dia.	Dash No.	A Dia.	B Dia.	Dash No.	A Dia.	B Dia.
	+002	+000		+002	+000		+002	+000		+002	+000		+002	+000
	-000	-002		-000	-002		-000	-002		-000	-002		-000	-002
010	0.350	0.250	044	3.850	3.750	134	2.037	1.875	168	7.412	7.250	227	2.347	2.125
011	0.412	0.312	045	4.100	4.000	135	2.099	1.937	169	7.662	7.500	228	2.472	2.250
012	0.475	0.375	046	4.350	4.250	136	2.162	2.000	170	7.912	7.750	229	2.597	2.375
013	0.537	0.437	047	4.600	4.500	137	2.224	2.062	171	8.162	8.000	230	2.722	2.500
014	0.600	0.500	048	4.850	4.750	138	2.287	2.125	172	8.412	8.250	231	2.847	2.625
015	0.662	0.562	049	5.100	5.000	139	2.349	2.187	173	8.662	8.500	232	2.972	2.750
016	0.725	0.625	050	5.350	5.250	140	2.412	2.250	174	8.912	8.750	233	3.097	2.875
017	0.787	0.687	107	0.381	0.219	141	2.474	2.312	175	9.162	9.000	234	3.222	3.000
018	0.850	0.750	108	0.412	0.250	142	2.537	2.375	176	9.412	9.250	235	3.347	3.125
019	0.912	0.812	109	0.474	0.312	143	2.599	2.437	177	9.662	9.500	236	3.472	3.250
020	0.975	0.875	110	0.537	0.375	144	2.662	2.500	178	9.912	9.750	237	3.597	3.375
021	1.037	0.937	111	0.599	0.437	145	2.724	2.562	204	0.597	0.375	238	3.722	3.500
022	1.100	1.000	112	0.662	0.500	146	2.787	2.625	205	0.659	0.437	239	3.847	3.625
023	1.162	1.062	113	0.724	0.562	147	2.849	2.687	206	0.722	0.500	240	3.972	3.750
024	1.225	1.125	114	0.787	0.625	148	2.912	2.750	207	0.784	0.562	241	4.097	3.875
025	1.287	1.187	115	0.849	0.687	149	2.974	2.812	208	0.847	0.625	242	4.222	4.000
026	1.350	1.250	116	0.912	0.750	150	3.037	2.875	209	0.909	0.687	243	4.347	4.125
027	1.412	1.312	117	0.974	0.812	151	3.162	3.000	210	0.972	0.750	244	4.472	4.250
028	1.475	1.375	118	1.037	0.875	152	3.412	3.250	211	1.034	0.812	245	4.597	4.375
029	1.600	1.500	119	1.099	0.937	153	3.662	3.500	212	1.097	0.875	246	4.722	4.500
030	1.725	1.625	120	1.162	1.000	154	3.912	3.750	213	1.159	0.937	247	4.847	4.625
031	1.850	1.750	121	1.224	1.062	155	4.162	4.000	214	1.222	1.000	248	4.972	4.750
032	1.975	1.875	122	1.287	1.125	156	4.412	4.250	215	1.284	1.062	249	5.097	4.875
033	2.100	2.000	123	1.349	1.187	157	4.662	4.500	216	1.347	1.125	250	5.222	5.000
034	2.225	2.125	124	1.412	1.250	158	4.912	4.750	217	1.409	1.187	251	5.347	5.125
035	2.350	2.250	125	1.474	1.312	159	5.162	5.000	218	1.472	1.250	252	5.472	5.250
036	2.475	2.375	126	1.537	1.375	160	5.412	5.250	219	1.534	1.312	253	5.597	5.375
037	2.600	2.500	127	1.599	1.437	161	5.662	5.500	220	1.597	1.375	254	5.722	5.500
038	2.725	2.625	128	1.662	1.500	162	5.912	5.750	221	1.659	1.437	255	5.847	5.625
039	2.850	2.750	129	1.724	1.562	163	6.162	6.000	222	1.722	1.500	256	5.972	5.750
040	2.975	2.875	130	1.787	1.625	164	6.412	6.250	223	1.847	1.625	257	6.097	5.875
041	3.100	3.000	131	1.849	1.687	165	6.662	6.500	224	1.972	1.750	258	6.222	6.000
042	3.350	3.250	132	1.912	1.750	166	6.912	6.750	225	2.097	1.875	259	6.472	6.250
043	3.600	3.500	133	1.974	1.812	167	7.162	7.000	226	2.222	2.000	260	6.722	6.500

Pressure Seals Inc. 81 Commerce Way, South Windsor, CT 06074

Phone: (877)-PSI-SEAL Toll Free, In CT: (860) 282-9100, Fax: (860) 282-9001



Pressure Seals, Inc.

Phone: (877)-PSI-SEAL Toll Free
 Thousands of Seals, O-Rings, and U-Cups
 World-Class Service since 1976!



TF 1188R continued

CODE IDENT. 07128

SEAL INSTALLATION
 I.D MOUNTED, STATIC ONLY
 COMMERCIAL-INDUSTRIAL STANDARD

Dash No.	A		B		Dash No.	A		B		Dash No.	A		B		Dash No.	A		B	
	Dia.	Dia.	Dia.	Dia.		Dia.	Dia.	Dia.	Dia.		Dia.	Dia.	Dia.	Dia.		Dia.			
	+002	+000		+002	+000		+002	+000		+002	+000		+002	+000		+002	+000		
	-000	-002		-000	-004		-000	-004		-000	-004		-000	-004		-000	-004		
261	6.972	6.750	318	1.340	1.000	351	5.090	4.750	384	15.340	15.000	446	8.952	8.500					
262	7.222	7.000	319	1.402	1.062	352	5.215	4.875	385	16.340	16.000	447	9.452	9.000					
263	7.472	7.250	320	1.465	1.125	353	5.340	5.000	386	17.340	17.000	448	9.952	9.500					
264	7.722	7.500	321	1.527	1.187	354	5.465	5.125	387	18.340	18.000	449	10.452	10.000					
265	7.972	7.750	322	1.590	1.250	355	5.590	5.250	388	19.340	19.000	450	10.952	10.500					
266	8.222	8.000	323	1.652	1.312	356	5.715	5.375	389	20.340	20.000	451	11.452	11.000					
267	8.472	8.250	324	1.715	1.375	357	5.840	5.500	390	21.340	21.000	452	11.952	11.500					
268	8.722	8.500	325	1.840	1.500	358	5.965	5.625	391	22.340	22.000	453	12.452	12.000					
269	8.972	8.750	326	1.965	1.625	359	6.090	5.750	392	23.340	23.000	454	12.952	12.500					
270	9.222	9.000	327	2.090	1.750	360	6.215	5.875	393	24.340	24.000	455	13.452	13.000					
271	9.472	9.250	328	2.215	1.875	361	6.340	6.000	394	25.340	25.000	456	13.952	13.500					
272	9.722	9.500	329	2.340	2.000	362	6.590	6.250	395	26.340	26.000	457	14.452	14.000					
273	9.972	9.750	330	2.465	2.125	363	6.840	6.500	425	4.952	4.500	458	14.952	14.500					
274	10.222	10.000	331	2.590	2.250	364	7.090	6.750	426	5.077	4.625	459	15.452	15.000					
275	10.722	10.500	332	2.715	2.375	365	7.340	7.000	427	5.202	4.750	460	15.952	15.500					
276	11.222	11.000	333	2.840	2.500	366	7.590	7.250	428	5.327	4.875	461	16.452	16.000					
277	11.722	11.500	334	2.965	2.625	367	7.840	7.500	429	5.452	5.000	462	16.952	16.500					
278	12.222	12.000	335	3.090	2.750	368	8.090	7.750	430	5.577	5.125	463	17.452	17.000					
279	13.222	13.000	336	3.215	2.875	369	8.340	8.000	431	5.702	5.250	464	17.952	17.500					
280	14.222	14.000	337	3.340	3.000	370	8.590	8.250	432	5.827	5.375	465	18.452	18.000					
281	15.222	15.000	338	3.465	3.125	371	8.840	8.500	433	5.952	5.500	466	18.952	18.500					
282	16.222	16.000	339	3.590	3.250	372	9.090	8.750	434	6.077	5.625	467	19.452	19.000					
283	17.222	17.000	340	3.715	3.375	373	9.340	9.000	435	6.202	5.750	468	19.952	19.500					
284	18.222	18.000	341	3.840	3.500	374	9.590	9.250	436	6.327	5.875	469	20.452	20.000					
	+002	+000	342	3.965	3.625	375	9.840	9.500	437	6.452	6.000	470	21.452	21.000					
	-000	-004	343	4.090	3.750	376	10.090	9.750	438	6.702	6.250	471	22.452	22.000					
311	0.902	0.562	344	4.215	3.875	377	10.340	10.000	439	6.952	6.500	472	23.452	23.000					
312	0.965	0.625	345	4.340	4.000	378	10.840	10.500	440	7.202	6.750	473	24.452	24.000					
313	1.027	0.687	346	4.465	4.125	379	11.340	11.000	441	7.452	7.000	474	25.452	25.000					
314	1.090	0.750	347	4.590	4.250	380	11.840	11.500	442	7.702	7.250	475	26.452	26.000					
315	1.152	0.812	348	4.715	4.375	381	12.340	12.000	443	7.952	7.500								
316	1.215	0.875	349	4.840	4.500	382	13.340	13.000	444	8.202	7.750								
317	1.277	0.937	350	4.965	4.625	383	14.340	14.000	445	8.452	8.000								

Pressure Seals Inc. 81 Commerce Way, South Windsor, CT 06074

Phone: (877)-PSI-SEAL Toll Free, In CT: (860) 282-9100, Fax: (860) 282-9001